

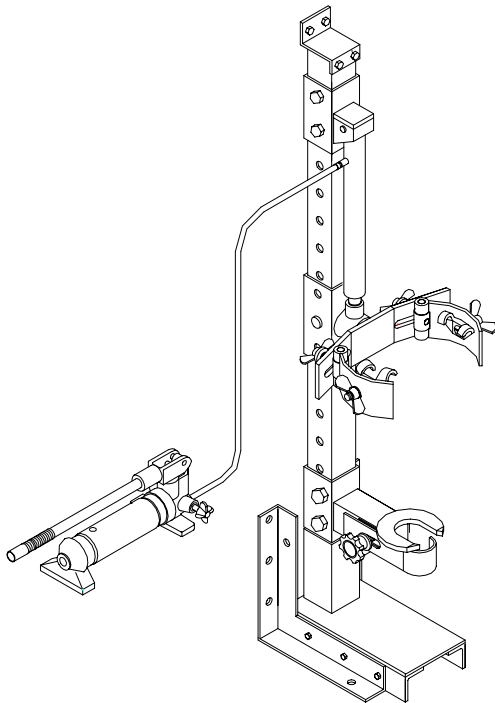

ATD TOOLS, INC.

PRODUCT SPECIFICATIONS

MODEL #:	7553
DESCRIPTION:	HEAVY DUTY HYDRAULIC STRUT SPRING COMPRESSOR
PRODUCT SIZE:	12 1/4" (L) X 11 7/8" (W) X 52 5/8" (H)
RECOMMENDED STRUT SPRING DIA.:	4" ~ 10"
HYDRAULIC STROKE:	10" (14 1/4" MAX. ~ 4 1/4" MIN.)
MAX. WORKING SPACE:	15 1/2"
PUMP SIZE:	12 7/8" (L) X 5 3/4" (W) X 5 1/8" (H)
HANDLE LENGTH:	16 7/8"
OPERATING FORCE:	119.0 LBS
VOLUME OF HD. OIL:	16.5 CU. IN. (270 C.C.)
TOTAL NET WEIGHT:	94.9 LBS
GROSS WEIGHT:	102.0 LBS
CARTON DIM.:	54 1/8" (L) X 13 5/8" (W) X 7 7/8" (H)
CUFT.:	3.35 CUFT (264 PCs/ 20' CTN)



FEATURE

- MAX. WORKING SPACE 15 1/2"
- HYDRAULIC STROKE 10"
- SMOOTH, LONG STROKE HYDRAULIC ACTUATOR
- ADJUSTABLE STRUT SHAFT CLASP SECURES THE STRUT DURING OPERATION
- ANGLE ROTATABLE SPRING CLASP BRACKET FITS MOST MODELS AND SIZES
- EXTENDABLE SPRING CLASP HOLDER WITH LINEAR ADJUSTMENT
- SLIDING RAM BRACKET PROVIDES MULTIPLE HEIGHT ADJUSTMENT
- OPTIONAL LEG ASSEMBLY FOR EASY MANEUVERABILITY